

FACADE

SAPA 4150 SX/PH

ENERGY EFFICIENT SOLUTION WITH SPECIALLY DESIGNED INSULATORS

SAPA 4150 SX/PH meets the strict passive house energy requirements set by the German certification IFT Rosenheim. The system achieves low $U_{cw} = 0.66 \text{ W/m}^2\text{K}$. The profile is energy efficient and with its elegant design it gives the exterior expression a smooth look.

Performance

- SAPA 4150 SX/PH is a rectangular profile in several dimensions to handle current loads.
- Profile width 50 mm.
- Profile depth SX 35–300 mm.
- Profile depth PH 120–300 mm.
- Glass thickness up to 64 mm.
- Produced with CIRCAL – a minimum of 75% recycled aluminium.
- Can be supplemented with openable units.
- PH-certificate passive house standard according to IFT Rosenheim.
- High insulation properties with newly developed insulator and internal joint tape.

Thermal performance

- The PH system achieves low $U_{cw} = 0.66 \text{ W/m}^2\text{K}$ according to IFT Rosenheim.

Sealing performance

- Air tightness: class AE1200 according to EN12152.
- Water resistance: class RE1200 according to EN12154.
- Wind load resistance: 2000Pa according to EN13116.

Safety

- Burglary protection class RC2 and RC3 according to EN1627.

Design

- Simple installation of openable units.
- Large assortment of profiles in several depths.
- I and T-profiles with great freedom for interior design.
- Great possibilities for exterior design with décor profiles. Glazing can be done with our ADD-profile for solar cells, sun protection, signs, lighting conductors.

Low carbon footprint

- SAPA 4150 SX/PH is made from Hydro CIRCAL, recycled low carbon aluminium. That means it's high quality aluminium made with a minimum of 75% recycled end-of-life aluminium (post-consumer scrap). Hydro CIRCAL has a carbon footprint of 2.3 kg of CO₂/kg of aluminium on average.

Thermal performance: U-value; $U_{cw} = 0.66 \text{ W/m}^2\text{K}$
 Air permeability: class AE1200 according to EN12152
 Water resistance: class RE1200 according to EN12154
 Wind load resistance: 2000Pa according to EN13116
 Sound reduction: $R_{cw} = 38\text{--}50\text{dB}$
 Burglary protection: class RC2 and RC3 according to EN1627
 Glass rebate: up to 64 mm



Applications

Facade system 4150 SX/PH profiles and transoms/mullions

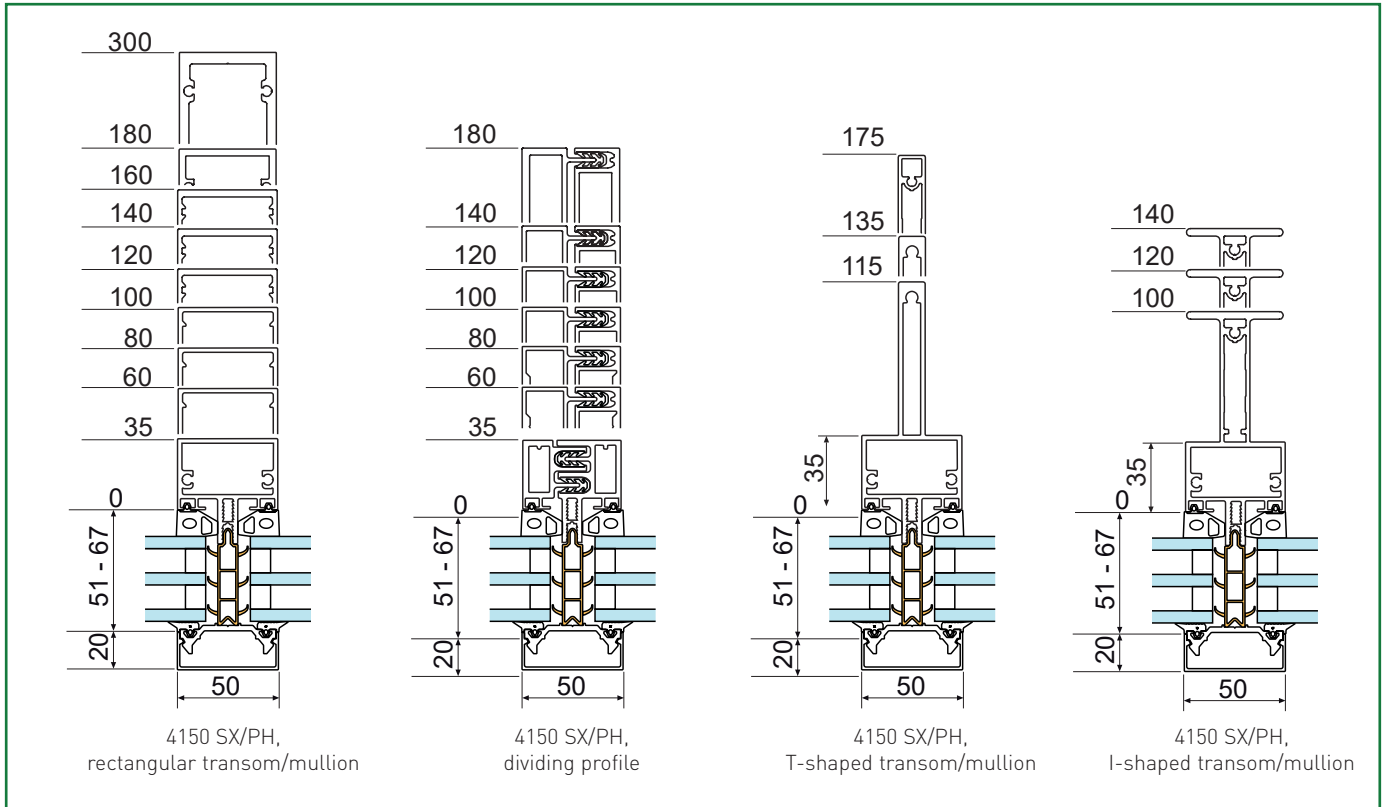

SAPA Facade System 4150 SX/PH, triple-glazed

Glass, U_g W/m²K (centre point). Spacer, warm edge

Profile share	0.5	0.6	0.7	0.8	0.9	1.0
5%	0.59	0.68	0.78	0.87	0.97	1.1
10%	0.69	0.78	0.87	0.96	1.0	1.1
15%	0.79	0.88	0.96	1.0	1.1	1.2

Profile share 5%: Glass sizes, approx. 2500 x 3000 mm

Profile share 10%: Glass sizes, approx. 1100 x 1500 mm

Profile share 15%: Glass sizes, approx. 800 x 800 mm

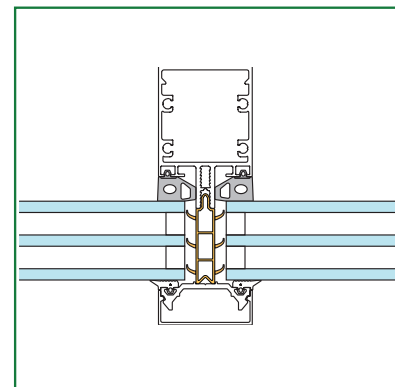

4150 SX/PH, triple-glazed unit



Hydro Building Systems Lithuania UAB
Kirtimų g. 47, Vilnius
LT-02244, Lithuania
www.sapabuildingsystem.com

sapa:

By  Hydro