



## FACADE

# SAPA 4150

## THE PROFILE WITH GREAT POSSIBILITIES FOR THE ARCHITECT'S PERSONAL EXPRESSIONS

SAPA 4150 is our ground recipe for facade solutions. The profile is designed to give stability against dimensioned loads, and is joined with hidden joints. The construction of the inner joint band and isolator provides an optimal insulation and the system can easily be supplemented with openable units.

### Performance

- SAPA 4150 is a rectangular profile in several dimensions to handle current loads.
- Profile width 50 mm.
- Stomp profile depth 35–300 mm.
- Standard glass thickness 23–48 mm (single glass can also be used internally).
- Produced with CIRCAL – a minimum of 75% recycled aluminium.
- Can be supplemented with openable units.
- An insulating step made of PVC, available in several variants depending on the desired u-value.
- Swing- and sliding doors can easily be connected.

### Thermal performance

- $U_{cw} = 0.8 \text{ W/m}^2\text{K}$  with glass  $U_g = 0.6$  and 5% profile share.

### Sealing performance

- Air tightness: class AE1200 according to EN12152
- Water resistance: class RE1200 according to EN12154.
- Wind load resistance: 2000Pa according to EN13116.

### Safety

- Burglary protection class RC2 and RC3 according to EN1627.

### Design

- Four window system, both inward and outward.
- Large assortment of frame profiles in several depths.
- I and T- profiles with great freedom for interior design.
- Great possibilities for exterior design with decorative profiles.
- Can also be mounted with solar cells, sun protection, signs, lighting conductors, downpipes, gutters etc.

### Low carbon footprint

- SAPA 4150 is made from Hydro CIRCAL, recycled low carbon aluminium. That means it's high quality aluminium made with a minimum of 75% recycled end-of-life aluminium (post-consumer scrap). Hydro CIRCAL has a carbon footprint of 2.3 kg of CO<sub>2</sub>/kg of aluminium on average.

Thermal performance: U-value:  $U_{cw} = 0.8 \text{ W/m}^2\text{K}$   
 Air permeability: class AE1200 according to EN12152  
 Water resistance: class RE1200 according to EN12154  
 Wind load resistance: 2000Pa according to EN13116  
 Sound reduction:  $R_{cw} = 38\text{--}50\text{dB}$   
 Burglary protection: class RC2 and RC3 according to EN1627  
 Glass rebate: 23–48 mm



## Applications

### Facade system 4150, selection of profiles

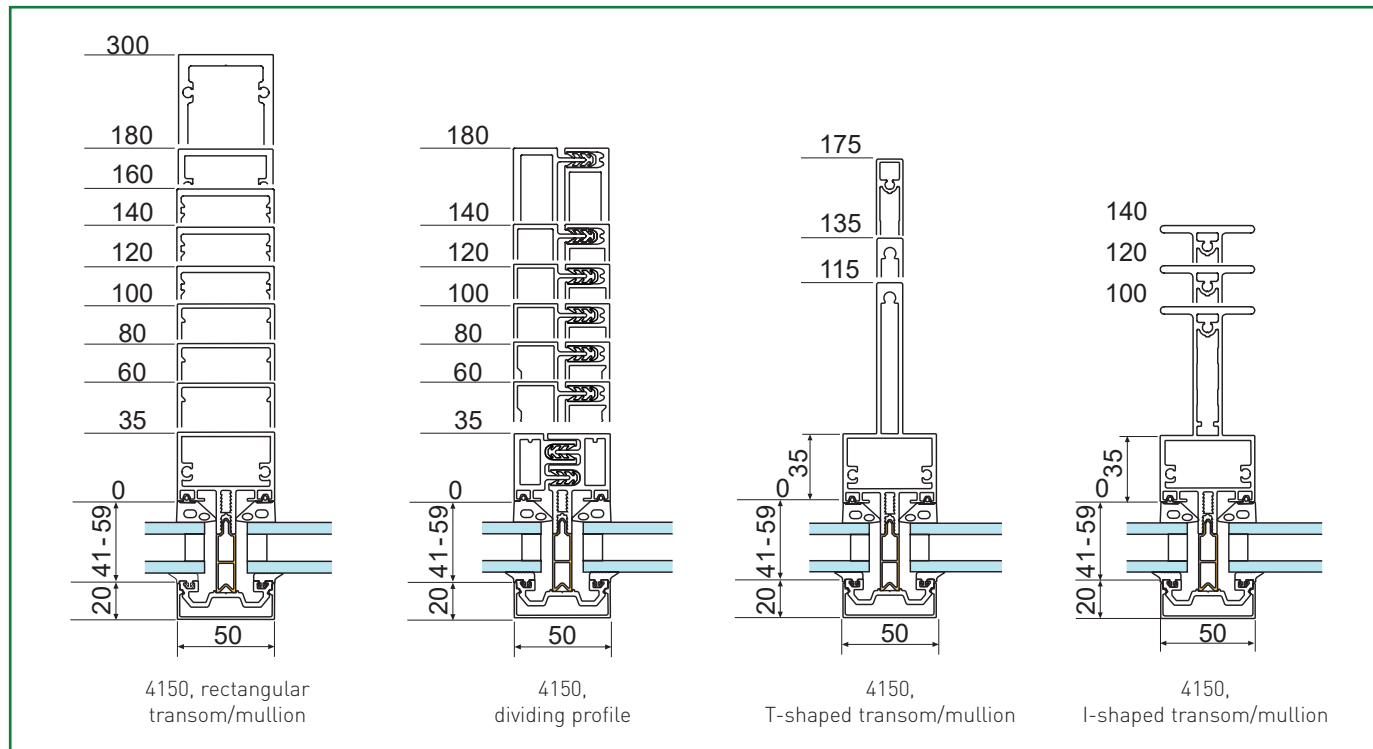

#### SAPA Facade System 4150, double-glazed

Glass,  $U_g$  W/m<sup>2</sup>K (centre point). Spacer, warm edge

Profile share	1.0	1.1	1.2	1.3	1.4	1.5	1.6
5%	1.1	1.2	1.3	1.4	1.5	1.6	1.7
10%	1.2	1.3	1.4	1.5	1.6	1.7	1.8
15%	1.4	1.5	1.6	1.6	1.7	1.8	1.9

#### SAPA Facade System 4150, triple-glazed

Glass,  $U_g$  W/m<sup>2</sup>K (centre point). Spacer, warm edge

Profile share	0.5	0.6	0.7	0.8	0.9	1.0
5%	0.60	0.70	0.79	0.89	0.98	1.1
10%	0.73	0.82	0.91	1.0	1.1	1.2
15%	0.85	0.94	1.0	1.1	1.2	1.3

Profile share 5%: Glass sizes, approx. 2500 x 3000 mm

Profile share 10%: Glass sizes, approx. 1100 x 1500 mm

Profile share 15%: Glass sizes, approx. 800 x 800 mm

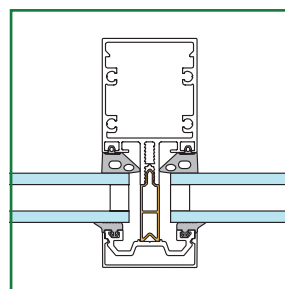

4150, double-glazed unit

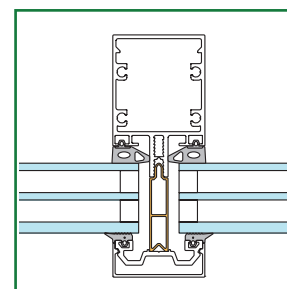

4150, triple-glazed unit

Hydro Building Systems Lithuania UAB  
Kirtimų g. 47, Vilnius  
LT-02244, Lithuania  
[www.sapabuildingsystem.com](http://www.sapabuildingsystem.com)

**sapa:**

By  Hydro